

FOR LEASE

1873 E. Main St, Ferndale, WA



Prime Office/ Retail, High Visibility in Heart of Ferndale's Commercial District

Suite 5: 2384 | Suite 7: 1,090 SF | Combine 5 & 7 for 3474 SF

- Ferndale Shops center is 5 miles North of Bellingham
- **Largest contiguous space is 3474SF**
- Join a healthy commercial community that includes O'Reilly's, Hair Masters, Dollar Tree, Thrive Fitness, Sonic Drive-In, Wells Fargo, a liquor and wine store and Woods Coffee, adjacent to Walgreens on Main Street
- Near Haggen Food & Pharmacy
- Parking on-site
- Easy access to I-5

CBA Bldg #208515  Listing #16733056



Sales, Leasing, Management
Office, Retail and Industrial Properties

114 W. Magnolia Street, Suite 302, Bellingham, WA 98225

For information contact:
Tracy Carpenter
or Jim Bjerke

(360) 671-4200 ext 114
tracy@pacificcontinentalrealty.com
jim@pacificcontinentalrealty.com

2017/03

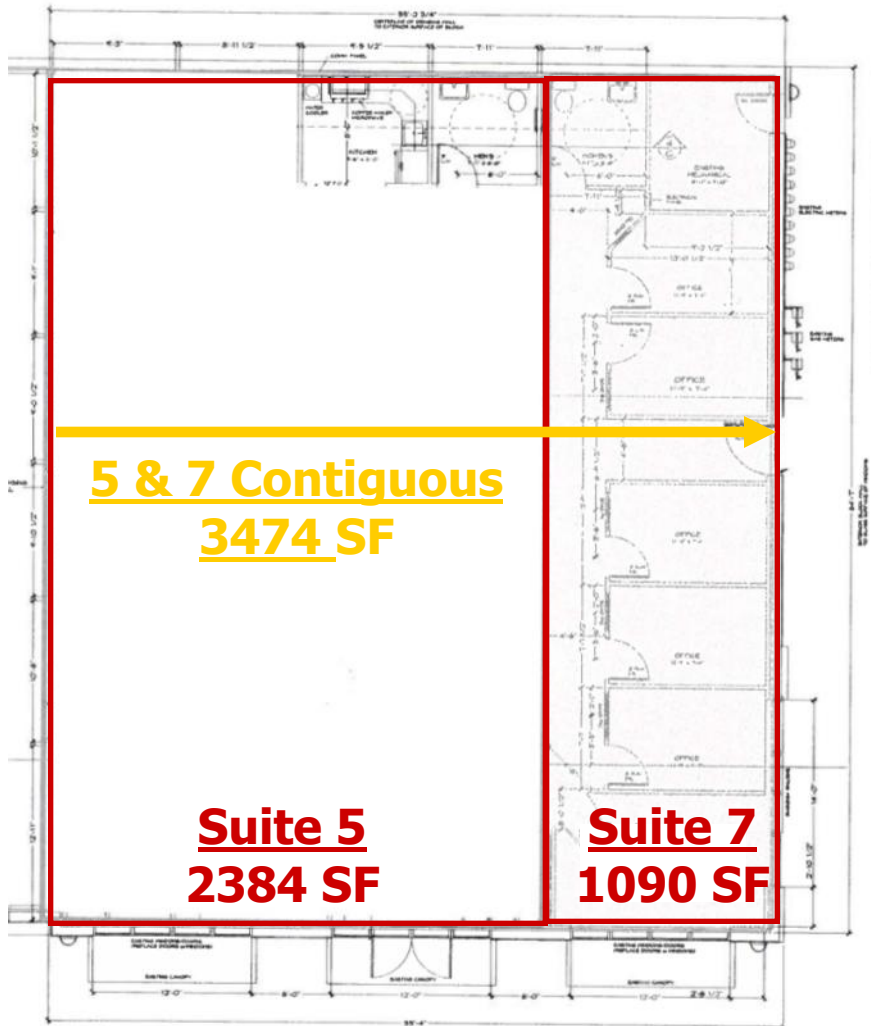

Sales, Leasing, Management
Office, Retail and Industrial Properties

114 W. Magnolia Street, Suite 302, Bellingham, WA 98225

For information contact:
Tracy Carpenter
or **Jim Bjerke**

(360) 671-4200 ext 114
tracy@pacificcontinentalrealty.com
jim@pacificcontinentalrealty.com

1873 Main Street

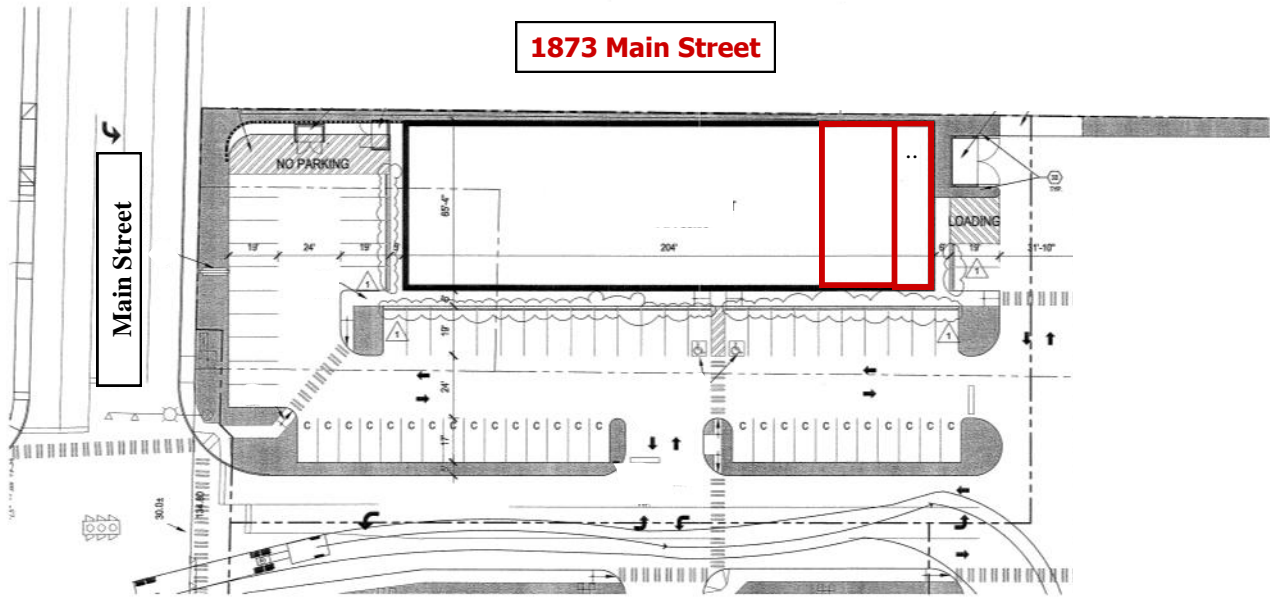

① SITE PLAN
SCALE: 1" = 20'-0"

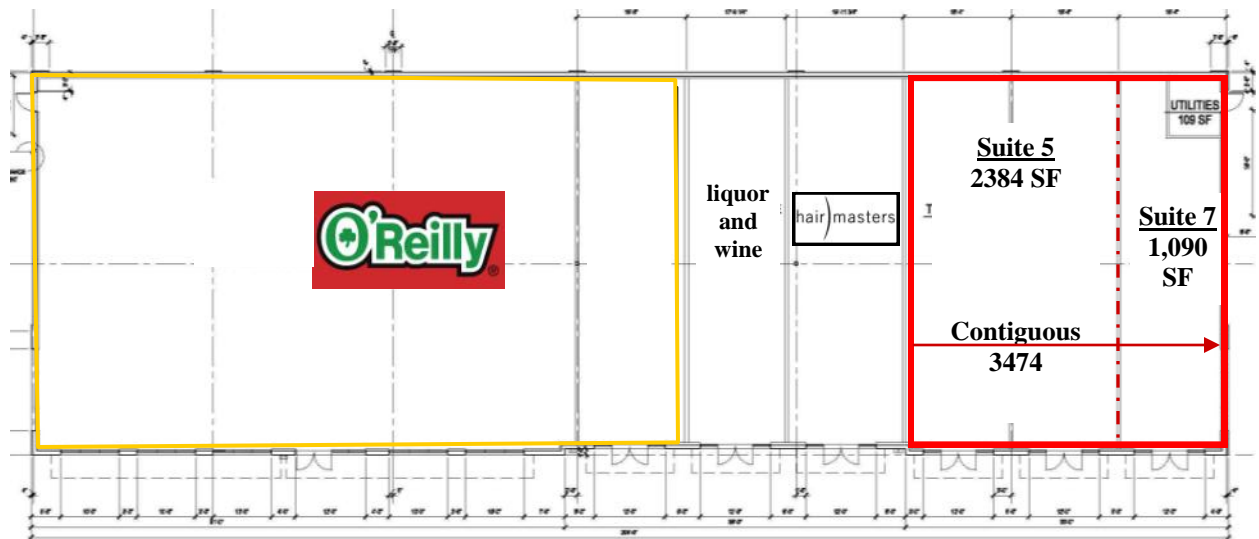

Pacific Continental Realty LLC
Sales, Leasing, Management
Office, Retail and Industrial Properties
114 W. Magnolia Street, Suite 302, Bellingham, WA 98225

For information contact:
Tracy Carpenter
or **Jim Bjerke**
(360) 671-4200 ext 114
tracy@pacificcontinentalrealty.com
jim@pacificcontinentalrealty.com

Information contained herein has been obtained from the owner of the property or from other sources that we deem reliable. We have no reason to doubt its accuracy, but we do not guarantee it.

Prime Office/ Retail, High Visibility in Heart of Ferndale's Commercial District

Suite 5: 2384 | Suite 7: 1,090 SF
Combine 5 & 7 for 3474 SF



Sales, Leasing, Management
Office, Retail and Industrial Properties

114 W. Magnolia Street, Suite 302, Bellingham, WA 98225

For information contact:
Tracy Carpenter
or **Jim Bjerke**

(360) 671-4200 ext 114
tracy@pacificcontinentalrealty.com
jim@pacificcontinentalrealty.com