

FOR LEASE



Prime Office Space in Marina Building 851 Coho Way

SUITE 301-312: 10,005 SF (DIVISIBLE TO 1313 SF) | SUITE 308: 1,074 SF

- Excellent views
- Unlimited parking
- Wired for high speed internet
- Great working environment
- Suites have opening windows
- Gas & electricity is separately metered
- Easy access to I-5
- High pride of ownership
- Elevator access
- Rents quoted include Triple Net costs
- Walking distance to Zuanich Park, Bellwether Hotel and numerous exceptional restaurants

CBA Property # 161601  Listing # 20137180



Sales, Leasing, Management
Office, Retail and Industrial Properties

114 W. Magnolia Street, Suite 302, Bellingham, WA 98225

For information contact:

Jim Bjerke

(360) 671-4200

jim@pacificcontinentalrealty.com

2017/05

MARINA BUILDING 851 COHO WAY

10,005 SF (DIVISIBLE TO 1313 SF)

Available suites
combined
equal 10,005 SF.

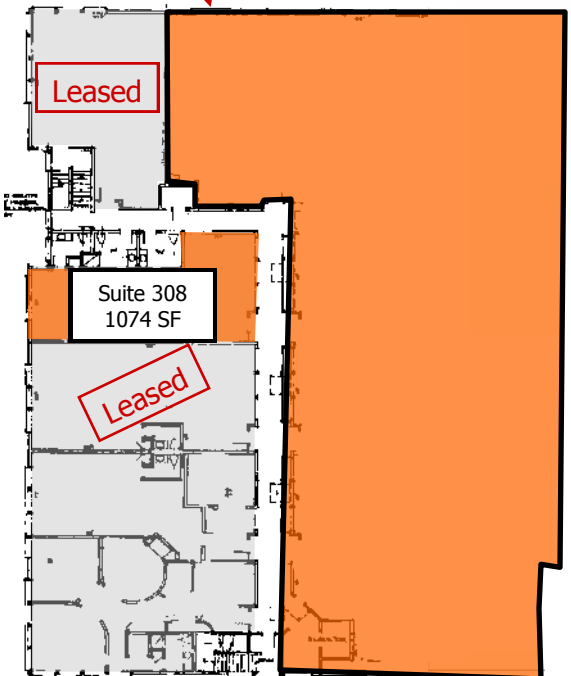
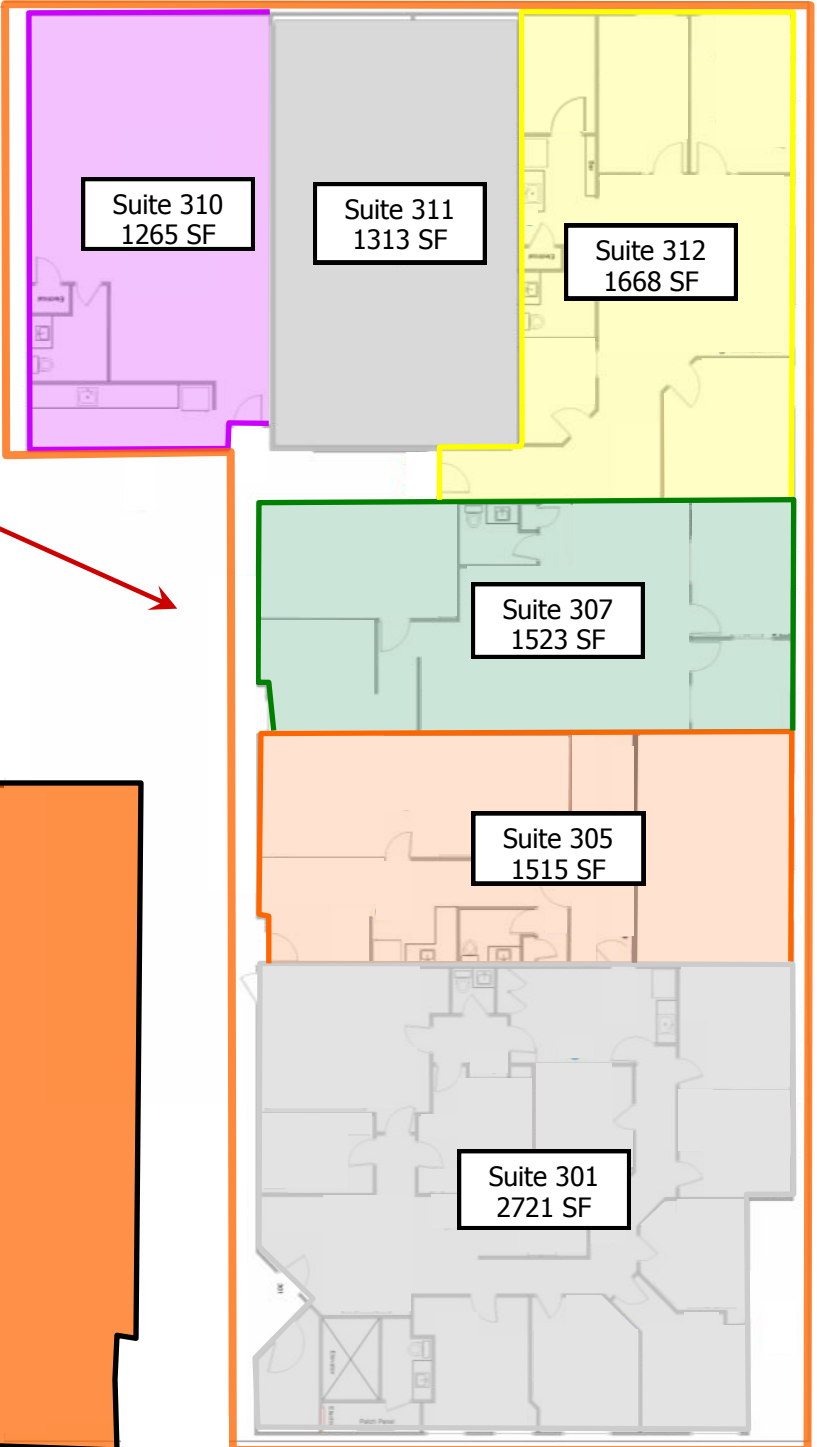



3RD FLOOR HALLWAY



**SUITE 311
THREE PRIVATE OFFICES WITH
KITCHENETTE
AND OPEN RECEPTION**

GREAT WORKING ENVIRONMENT



Professional Office Space at Squalicum Harbor



Sales, Leasing, Management
Office, Retail and Industrial Properties
114 W. Magnolia Street, Suite 302, Bellingham, WA 98225

For information contact:

Jim Bjerke

(360) 671-4200

jjm@pacificcontinentalrealty.com

Information contained herein has been obtained from the owner of the property or from other sources that we deem reliable. We have no reason to doubt its accuracy, but we do not guarantee it.